

For Low Pressure

Lever Lock Cupla

Metal Body / Plastic Body

For bulk flow, low pressure applications

| | | | |
|--|--|--|--|
| <p>Working pressure</p> <p>0.7 to 1.8</p> <p>0.7 to 1.8 MPa (7 to 18 kgf/cm²)</p> | <p>Working pressure</p> <p>0.2 to 0.5</p> <p>0.2 to 0.5 MPa (2 to 5 kgf/cm²)</p> | <p>Valve structure</p> <p>Straight through</p> | <p>Designs and specifications are subject to change for improvement without notice</p> |
| <p>Applicable fluids (plastic body Cuplas are for water or air only)</p> <p>Water Hydraulic oil Air Powder Steam</p> | | | |

Note: Depending on the temperature of steam/hot water, the heat may damage seal materials.

Light lever pull-down will connect the plug and socket without fail ready to flow liquid or gases.

- This Cupla complies with diversified applications in liquid or gas transportation.
- End-face seal structure enables no bumps or hollows on the internal fluid passage, and ensures smooth fluid transportation.
- A special lip packing (except sizes 3/4 and 1", silicone rubber, and FEP-covered rubber) employed reduces the load to the lever for easy operation.
- Connection part dimensions comply with US military specifications MIL-A-A-59326.
- The variety of body materials, sizes and end configurations has been standardized to comply with wide range of applications.
- Additional stopper function design will enhance safety (only for made-to-order metal body product).

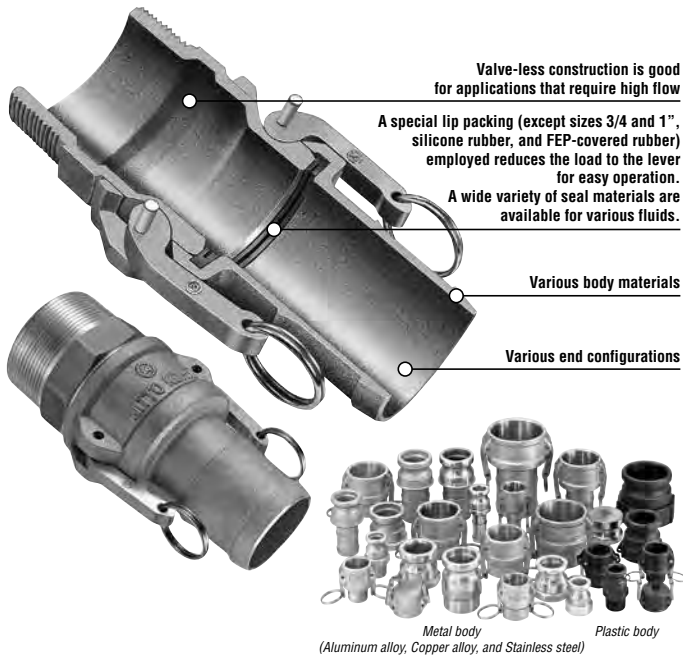

Specifications (Metal Body)

| | | | | | | | | |
|---------------------------------|--|--------|------|-----|-----------------------|---------------------------|---------------------------|-----------------|
| Body material (Material symbol) | Aluminum alloy (AL), Copper alloy (BR) | | | | Stainless steel (SUS) | | | |
| Size (Thread and hose) | 3/4" to 2" | 2 1/2" | 3" | 4" | 3/4" to 2" | 2 1/2" to 3" | 4" | |
| Working pressure | MPa | 1.8 | 1.1 | 0.9 | 0.7 | 1.8 | 1.6 | 1.1 |
| | kgf/cm ² | 18 | 11 | 9 | 7 | 18 | 16 | 11 |
| | bar | 18 | 11 | 9 | 7 | 18 | 16 | 11 |
| | PSI | 261 | 160 | 131 | 102 | 261 | 232 | 160 |
| Seal material | Nitrile rubber | | Mark | | NBR (SG) | | Working temperature range | -20°C to +80°C |
| Optional seal material | Silicone rubber | | Mark | | SI | | Working temperature range | -40°C to +150°C |
| | Fluoro rubber | | Mark | | FKM (X-100) | | Working temperature range | -20°C to +180°C |
| | Ethylene-propylene rubber | | Mark | | EPDM (EPT) | | Working temperature range | -40°C to +150°C |
| | FEP-covered silicon rubber* | | Mark | | — | | Working temperature range | +5°C to +50°C |
| FEP-covered fluoro rubber* | | Mark | | — | | Working temperature range | +5°C to +50°C | |

*Made-to-order item (Working pressure : 0.2 MPa (2 kgf/cm²))

Specifications (Plastic Body)

| | | | | |
|---------------------------------|---------------------------|------|---------------------------|---------------|
| Body material (Material symbol) | Polypropylene (PP) | | | |
| Size (Thread and hose) | 3/4", 1", 1 1/2" | | 2", 3" | |
| Working pressure* | MPa | 0.5 | 0.2 | |
| | kgf/cm ² | 5 | 2 | |
| | bar | 5 | 2 | |
| | PSI | 72.5 | 29 | |
| Seal material | Nitrile rubber | | Working temperature range | +5°C to +50°C |
| Optional seal material | Silicone rubber | | Working temperature range | +5°C to +50°C |
| | Fluoro rubber | | Working temperature range | +5°C to +50°C |
| | Ethylene-propylene rubber | | Working temperature range | +5°C to +50°C |

*Pressure at 20°C. Pressure reduces as temperature rises.

Max. Tightening Torque

| Size (Thread) | 3/4" | 1" | 1 1/4" | 1 1/2" | 2" | 2 1/2" | 3" | 4" |
|---------------|-----------------|-------|--------|--------|--------|--------|--------|--------|
| Torque | Aluminum alloy | 50 | 70 | 120 | 140 | 260 | 350 | 470 |
| | Copper alloy | (510) | (714) | (1224) | (1428) | (2652) | (3570) | (4794) |
| | Stainless steel | 90 | 120 | 220 | 260 | 350 | 480 | 590 |
| | | (918) | (1224) | (2244) | (2652) | (3570) | (4896) | (6018) |

Flow Direction

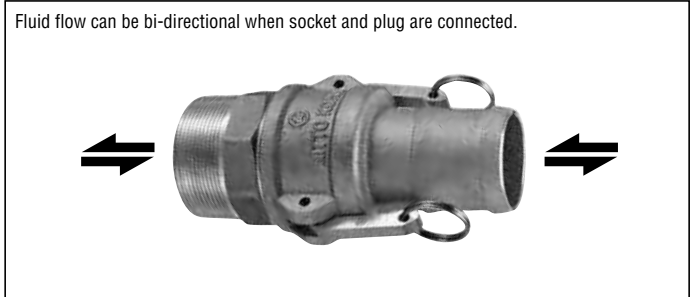

Interchangeability

Same size sockets and plugs are interchangeable regardless of their end configurations. Connection part dimensions are in compliance with MIL-A-A-59326.

Suitability for Vacuum (Metal Body)

| | | |
|-------------|-----------|----------------------------|
| | | 53.0 kPa {400 mmHg} |
| Socket only | Plug only | When connected |
| — | — | Operational |

Suitability for Vacuum (Plastic Body)

Not suitable for vacuum application in either connected or disconnected condition.

Dimensions with Lever Fully Opened

| | | | | |
|-------|--------|-------------------|---------|-------|
| Metal | Size | Dimensions E (mm) | | |
| | | Body material | | |
| | | AL | BR | SUS |
| E | 3/4" | (122.5) | (122.5) | (111) |
| | 1" | (132) | (132) | (125) |
| | 1 1/4" | (183) | (183) | (179) |
| | 1 1/2" | (191) | (191) | (187) |
| | 2" | (201) | (201) | (196) |
| | 2 1/2" | (213) | (209) | (209) |
| | 3" | (249) | (249) | (251) |
| | 4" | (280) | (278) | (277) |

| | | | |
|---------|-------|--------|-------------------|
| Plastic | E | Size | Dimensions E (mm) |
| | | 3/4" | (115) |
| | | 1" | (126) |
| | | 1 1/2" | (187) |
| | | 2" | (195) |
| 3" | (249) | | |

Models and Dimensions

Dimensions of products may differ according to body material. / WAF : WAF stands for width across flats.

Plug LE type (Hose barb)

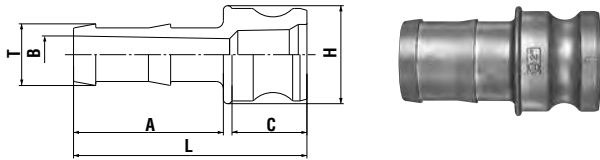

| Material | Model | Application (Hose) | Mass (g) | Dimensions (mm) | | | | | | |
|-----------------|--------------|--------------------|----------|-----------------|------|------|------|------|------|------|
| | | | | L | A | C | øH | øT | øB | |
| Aluminum alloy | LE-6TPH | 3/4" | 65 | 81 | 52 | 26 | 34 | 21.4 | 11 | |
| | LE-8TPH | 1" | 100 | 95 | 58 | 34 | 40 | 27.4 | 17.5 | |
| | LE-10TPH | 1 1/4" | 140 | 102 | 58 | 40 | 48 | 34.1 | 23.5 | |
| | LE-12TPH | 1 1/2" | 190 | 107 | 61 | 42 | 58 | 40.5 | 29 | |
| | LE-16TPH | 2" | 290 | 122 | 70 | 48 | 69 | 53.2 | 40 | |
| | LE-20TPH | 2 1/2" | 390 | 134.5 | 80 | 50 | 81 | 66.7 | 50 | |
| | LE-24TPH | 3" | 545 | 167 | 101 | 61.5 | 97 | 79 | 68 | |
| | LE-32TPH | 4" | 850 | 176 | 109 | 57 | 129 | 105 | 93 | |
| | Copper alloy | LE-6TPH | 3/4" | 215 | 90.5 | 52.5 | 26 | 39 | 21.5 | 12.5 |
| | | LE-8TPH | 1" | 305 | 107 | 60 | 34.5 | 41 | 27.5 | 20 |
| LE-10TPH | | 1 1/4" | 440 | 102 | 58 | 40 | 48 | 34.1 | 25.5 | |
| LE-12TPH | | 1 1/2" | 560 | 107 | 61 | 42 | 58 | 40.5 | 31.5 | |
| LE-16TPH | | 2" | 865 | 131 | 73 | 54 | 70.5 | 53.5 | 44.5 | |
| LE-20TPH | | 2 1/2" | 1180 | 149 | 84 | 48 | 91 | 67 | 57 | |
| LE-24TPH | | 3" | 1800 | 162 | 99.5 | 56.5 | 102 | 78 | 68 | |
| LE-32TPH | | 4" | 3500 | 176 | 109 | 57 | 129 | 105 | 93 | |
| Stainless steel | | LE-6TPH | 3/4" | 170 | 90 | 52 | 35.5 | 35 | 21 | 15 |
| | | LE-8TPH | 1" | 265 | 107 | 60 | 44 | 42 | 27 | 20 |
| | LE-10TPH | 1 1/4" | 430 | 111 | 61 | 40 | 48 | 34 | 25.5 | |
| | LE-12TPH | 1 1/2" | 530 | 114 | 61 | 40 | 60 | 40 | 33 | |
| | LE-16TPH | 2" | 790 | 131 | 73 | 45 | 70 | 53 | 44 | |
| | LE-20TPH | 2 1/2" | 1195 | 137 | 80.5 | 50.5 | 83 | 67 | 56 | |
| | LE-24TPH | 3" | 1755 | 162 | 99.5 | 56.5 | 102 | 78 | 68 | |
| LE-32TPH | 4" | 2595 | 174 | 109 | 59 | 130 | 105 | 94 | | |

Socket LC type (Hose barb)

Model LC-6TSH made of aluminum alloy and copper alloy has no rings.

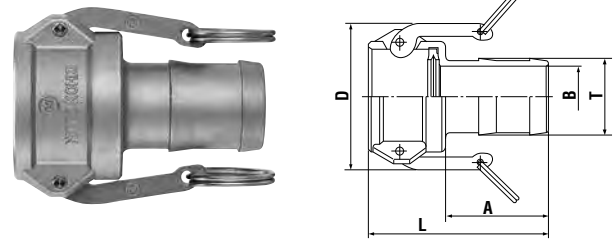

| Material | Model | Application (Hose) | Mass (g) | Dimensions (mm) | | | | | |
|-----------------|--------------|--------------------|----------|-----------------|-------|--------|--------|--------|------|
| | | | | L | A | D | øT | øB | |
| Aluminum alloy | LC-6TSH | 3/4" | 140 | 85 | 52 | (60.5) | 21.4 | (11) | |
| | LC-8TSH | 1" | 190 | 99 | 58 | (61) | 27.4 | (17.4) | |
| | LC-10TSH | 1 1/4" | 320 | 104 | 58 | (82) | 34.1 | (23.4) | |
| | LC-12TSH | 1 1/2" | 350 | 108.5 | 61 | (90) | 40.5 | (29.2) | |
| | LC-16TSH | 2" | 430 | 122.5 | 70 | (100) | 53.2 | 41.4 | |
| | LC-20TSH | 2 1/2" | 560 | 136.5 | 80 | (112) | 66.7 | 54.1 | |
| | LC-24TSH | 3" | 915 | 175 | 100 | (139) | 79 | 68 | |
| | LC-32TSH | 4" | 1190 | 180 | 104 | (165) | 104 | 93 | |
| | Copper alloy | LC-6TSH | 3/4" | 320 | 85 | 52 | (60.5) | 21.4 | 13 |
| | | LC-8TSH | 1" | 420 | 99 | 58 | (61) | 27.4 | 19.5 |
| LC-10TSH | | 1 1/4" | 700 | 104 | 58 | (82) | 34.1 | 23.4 | |
| LC-12TSH | | 1 1/2" | 720 | 110 | 62 | (91) | 41 | 33 | |
| LC-16TSH | | 2" | 870 | 121 | 70 | (100) | 53 | 44 | |
| LC-20TSH | | 2 1/2" | 1530 | 137 | 83 | (113) | 67 | 57 | |
| LC-24TSH | | 3" | 1795 | 160 | 105 | (139) | 79 | 68 | |
| LC-32TSH | | 4" | 3100 | 163 | 107 | (168) | 104 | 92 | |
| Stainless steel | | LC-6TSH | 3/4" | 230 | 86 | 52 | (55) | 21 | 15 |
| | | LC-8TSH | 1" | 340 | 99 | 60 | (63) | 27 | 20 |
| | LC-10TSH | 1 1/4" | 615 | 107 | 61 | (85) | 34 | 25.5 | |
| | LC-12TSH | 1 1/2" | 645 | 108 | 61 | (91) | 40 | 33 | |
| | LC-16TSH | 2" | 1000 | 129 | 73 | (101) | 53 | 44 | |
| | LC-20TSH | 2 1/2" | 1270 | 134 | 81 | (113) | 67 | 57 | |
| | LC-24TSH | 3" | 2065 | 158 | 100 | (139) | 79 | 67 | |
| LC-32TSH | 4" | 3020 | 165 | 107 | (167) | 105 | 94 | | |

Plug LA type (Female thread)

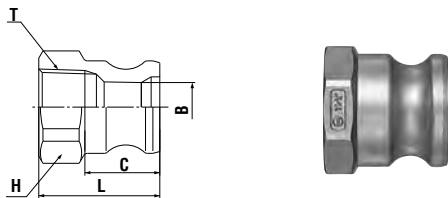

| Material | Model | Application (Thread) | Mass (g) | Dimensions (mm) | | | | | |
|-----------------|--------------|----------------------|----------|-----------------|---------|---------|--------|----------|--------|
| | | | | L | C | H(WAF) | øB | T | |
| Aluminum alloy | LA-6TPF | 3/4" | 45 | 42 | 26 | Hex.36 | 17 | Rc 3/4 | |
| | LA-8TPF | 1" | 65 | 52 | 34 | Hex.41 | 22.5 | Rc 1 | |
| | LA-10TPF | 1 1/4" | 110 | 59 | 40 | Hex.50 | 27.5 | Rc 1 1/4 | |
| | LA-12TPF | 1 1/2" | 130 | 58 | 42 | Hex.60 | 34.5 | Rc 1 1/2 | |
| | LA-16TPF | 2" | 170 | 63.5 | 48 | Oct.70 | 44.5 | Rc 2 | |
| | LA-20TPF | 2 1/2" | 320 | 85 | 50 | Oct.85 | 55.5 | Rc 2 1/2 | |
| | LA-24TPF | 3" | 370 | 79 | 52.5 | Dod.99 | 73.5 | Rc 3 | |
| | LA-32TPF | 4" | 640 | 82 | 54 | Dod.130 | 100 | Rc 4 | |
| | Copper alloy | LA-6TPF | 3/4" | 145 | 42 | 27 | Oct.34 | 20 | Rc 3/4 |
| | | LA-8TPF | 1" | 190 | 46 | 32 | Oct.41 | 24 | Rc 1 |
| LA-10TPF | | 1 1/4" | 390 | 59 | 40 | Hex.50 | 28 | Rc 1 1/4 | |
| LA-12TPF | | 1 1/2" | 420 | 58 | 42 | Oct.60 | 36 | Rc 1 1/2 | |
| LA-16TPF | | 2" | 560 | 63.5 | 48 | Oct.70 | 45 | Rc 2 | |
| LA-20TPF | | 2 1/2" | 950 | 79 | 50 | Dod.84 | 56 | Rc 2 1/2 | |
| LA-24TPF | | 3" | 1210 | 71 | 50 | Dod.101 | 70 | Rc 3 | |
| LA-32TPF | | 4" | 1620 | 79 | 53 | Dod.127 | 101 | Rc 4 | |
| Stainless steel | | LA-6TPF | 3/4" | 120 | 39 | 27 | Oct.33 | 19 | Rc 3/4 |
| | | LA-8TPF | 1" | 170 | 47 | 33 | Oct.41 | 24 | Rc 1 |
| | LA-10TPF | 1 1/4" | 270 | 53.5 | 41 | Oct.50 | 28 | Rc 1 1/4 | |
| | LA-12TPF | 1 1/2" | 375 | 55 | 40 | Oct.58 | 35.5 | Rc 1 1/2 | |
| | LA-16TPF | 2" | 505 | 62 | 47 | Oct.69 | 45 | Rc 2 | |
| | LA-20TPF | 2 1/2" | 825 | 77 | 49 | Dod.83 | 56 | Rc 2 1/2 | |
| | LA-24TPF | 3" | 875 | 72 | 51 | Dod.96 | 73 | Rc 3 | |
| LA-32TPF | 4" | 1470 | 79 | 53 | Dod.124 | 100 | Rc 4 | | |

Socket LD type (Female thread)

Model LD-6TSF made of aluminum alloy and copper alloy has no rings.

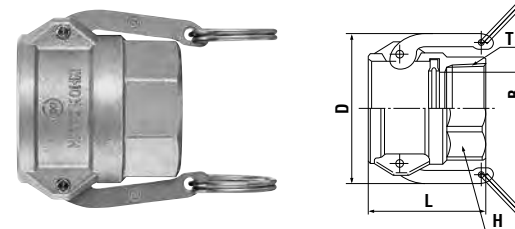

| Material | Model | Application (Thread) | Mass (g) | Dimensions (mm) | | | | | |
|-----------------|--------------|----------------------|----------|-----------------|---------|---------|--------|----------|--------|
| | | | | L | D | H(WAF) | øB | T | |
| Aluminum alloy | LD-6TSF | 3/4" | 130 | 53 | (62.4) | Hex.36 | 21 | Rc 3/4 | |
| | LD-8TSF | 1" | 190 | 64.5 | (61) | Hex.41 | 26 | Rc 1 | |
| | LD-10TSF | 1 1/4" | 330 | 72.5 | (82) | Hex.50 | 34 | Rc 1 1/4 | |
| | LD-12TSF | 1 1/2" | 360 | 70.5 | (90) | Hex.60 | 39 | Rc 1 1/2 | |
| | LD-16TSF | 2" | 420 | 79.5 | (100) | Oct.70 | 49 | Rc 2 | |
| | LD-20TSF | 2 1/2" | 550 | 88.5 | (112) | Oct.85 | 59 | Rc 2 1/2 | |
| | LD-24TSF | 3" | 800 | 89 | (140) | Dod.99 | 75 | Rc 3 | |
| | LD-32TSF | 4" | 1140 | 93 | (165) | Dod.131 | 94 | Rc 4 | |
| | Copper alloy | LD-6TSF | 3/4" | 310 | 53 | (60.5) | Hex.36 | 21 | Rc 3/4 |
| | | LD-8TSF | 1" | 430 | 64.5 | (61) | Hex.41 | 26 | Rc 1 |
| LD-10TSF | | 1 1/4" | 730 | 72.5 | (82) | Hex.50 | 34 | Rc 1 1/4 | |
| LD-12TSF | | 1 1/2" | 770 | 70.5 | (90) | Oct.60 | 39 | Rc 1 1/2 | |
| LD-16TSF | | 2" | 990 | 79.5 | (100) | Oct.70 | 49 | Rc 2 | |
| LD-20TSF | | 2 1/2" | 1290 | 81.5 | (113) | Dod.84 | 61 | Rc 2 1/2 | |
| LD-24TSF | | 3" | 1560 | 87 | (139) | Oct.96 | 77 | Rc 3 | |
| LD-32TSF | | 4" | 3590 | 91 | (165) | Dod.126 | 96 | Rc 4 | |
| Stainless steel | | LD-6TSF | 3/4" | 225 | 52 | (55) | Oct.32 | 19 | Rc 3/4 |
| | | LD-8TSF | 1" | 350 | 60 | (63) | Oct.41 | 24 | Rc 1 |
| | LD-10TSF | 1 1/4" | 600 | 68 | (85) | Oct.50 | 30 | Rc 1 1/4 | |
| | LD-12TSF | 1 1/2" | 715 | 72 | (87) | Oct.58 | 37.5 | Rc 1 1/2 | |
| | LD-16TSF | 2" | 940 | 78.5 | (100) | Oct.69 | 50 | Rc 2 | |
| | LD-20TSF | 2 1/2" | 1050 | 82 | (113) | Dod.83 | 61 | Rc 2 1/2 | |
| | LD-24TSF | 3" | 1605 | 84 | (140) | Dod.97 | 77 | Rc 3 | |
| LD-32TSF | 4" | 2575 | 94 | (167) | Dod.125 | 97 | Rc 4 | | |

Before use, please be sure to read "Safety Guide" described at the end of this book and "Instruction Sheet" that comes with the products.

Dimensions of products may differ according to body material. / WAF : WAF stands for width across flats.

Models and Dimensions

Plug LF type (Male thread)

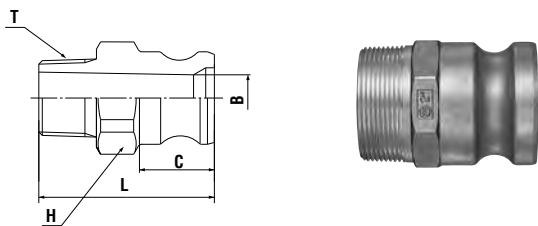

| Material | Model | Application (Thread) | Mass (g) | Dimensions (mm) | | | | |
|-----------------|--------------|----------------------|----------|-----------------|------|---------|--------|---------|
| | | | | L | C | H(WAF) | øB | T |
| Aluminum alloy | LF-6TPM | 3/4" | 70 | 61 | 26 | Hex.36 | 16 | R 3/4 |
| | LF-8TPM | 1" | 90 | 73 | 34 | Hex.41 | 22 | R 1 |
| | LF-10TPM | 1 1/4" | 140 | 81 | 40 | Hex.50 | 28 | R 1 1/4 |
| | LF-12TPM | 1 1/2" | 150 | 80.5 | 42 | Oct.55 | 34.5 | R 1 1/2 |
| | LF-16TPM | 2" | 220 | 89.5 | 48 | Oct.65 | 44.5 | R 2 |
| | LF-20TPM | 2 1/2" | 370 | 101 | 50 | Oct.80 | 56 | R 2 1/2 |
| | LF-24TPM | 3" | 470 | 106 | 52 | Dod.99 | 73 | R 3 |
| | LF-32TPM | 4" | 875 | 116 | 54 | Dod.130 | 100 | R 4 |
| | Copper alloy | LF-6TPM | 3/4" | 185 | 59 | 27 | Oct.34 | 20 |
| LF-8TPM | | 1" | 280 | 69 | 32 | Oct.41 | 24 | R 1 |
| LF-10TPM | | 1 1/4" | 460 | 81 | 40 | Hex.50 | 28 | R 1 1/4 |
| LF-12TPM | | 1 1/2" | 500 | 80.5 | 42 | Oct.55 | 36 | R 1 1/2 |
| LF-16TPM | | 2" | 750 | 89.5 | 48 | Oct.65 | 45 | R 2 |
| LF-20TPM | | 2 1/2" | 1290 | 98 | 50 | Dod.83 | 56 | R 2 1/2 |
| LF-24TPM | | 3" | 1480 | 103 | 50.8 | Dod.96 | 73 | R 3 |
| LF-32TPM | | 4" | 3155 | 113 | 53 | Dod.126 | 100 | R 4 |
| Stainless steel | | LF-6TPM | 3/4" | 175 | 59 | 27 | Oct.33 | 19 |
| | LF-8TPM | 1" | 255 | 69 | 33 | Oct.41 | 24 | R 1 |
| | LF-10TPM | 1 1/4" | 415 | 80 | 42 | Oct.50 | 29.5 | R 1 1/4 |
| | LF-12TPM | 1 1/2" | 575 | 80 | 40 | Oct.58 | 36.5 | R 1 1/2 |
| | LF-16TPM | 2" | 680 | 90 | 46.5 | Oct.69 | 46 | R 2 |
| | LF-20TPM | 2 1/2" | 1020 | 99 | 49 | Dod.83 | 56 | R 2 1/2 |
| | LF-24TPM | 3" | 1415 | 103 | 51 | Dod.96 | 73 | R 3 |
| | LF-32TPM | 4" | 2275 | 112 | 53 | Dod.124 | 100 | R 4 |

Socket LB type (Male thread)

Model LB-6TSM made of aluminum alloy has no rings.

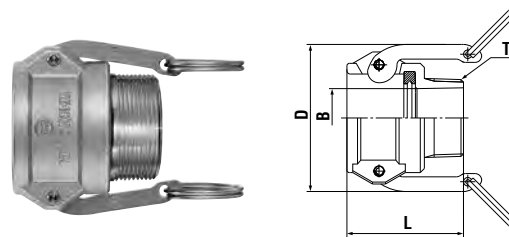

| Material | Model | Application (Thread) | Mass (g) | Dimensions (mm) | | | |
|--|-----------------------------------|----------------------|----------|-----------------|--------|-------|---------|
| | | | | L | D | øB | T |
| Aluminum alloy | LB-6TSM | 3/4" | 110 | 53 | (60.5) | 17.2 | R 3/4 |
| | LB-8TSM | 1" | 170 | 65 | (61) | 23.6 | R 1 |
| | LB-10TSM | 1 1/4" | 310 | 72 | (82) | 29.5 | R 1 1/4 |
| | LB-12TSM | 1 1/2" | 340 | 71.5 | (90) | 36 | R 1 1/2 |
| | LB-16TSM | 2" | 400 | 79.5 | (100) | 45.9 | R 2 |
| | LB-20TSM | 2 1/2" | 530 | 88.5 | (112) | 57.7 | R 2 1/2 |
| | LB-24TSM | 3" | 715 | 90 | (139) | 76 | R 3 |
| | LB-32TSM | 4" | 920 | 92 | (165) | 99 | R 4 |
| | Copper alloy (Made-to-order item) | LB-6TSM | 3/4" | 260 | 52 | (53) | 19.5 |
| LB-8TSM | | 1" | 355 | 63 | (62) | 26 | R 1 |
| LB-10TSM | | 1 1/4" | 620 | 71 | (84) | 28 | R 1 1/4 |
| LB-12TSM | | 1 1/2" | 700 | 71 | (91) | 36 | R 1 1/2 |
| LB-16TSM | | 2" | 950 | 81 | (100) | 51 | R 2 |
| LB-20TSM | | 2 1/2" | 1250 | 86 | (113) | 63 | R 2 1/2 |
| LB-24TSM | | 3" | 1780 | 92 | (139) | 78 | R 3 |
| LB-32TSM | | 4" | 2540 | 98 | (168) | 101 | R 4 |
| Stainless steel (Available on request) | | LB-6TSM | 3/4" | 210 | 52.5 | (55) | 20 |
| | LB-8TSM | 1" | 300 | 63 | (63) | 25.5 | R 1 |
| | LB-10TSM | 1 1/4" | 520 | 70.5 | (85) | 34 | R 1 1/4 |
| | LB-12TSM | 1 1/2" | 580 | 71.5 | (87) | 38 | R 1 1/2 |
| | LB-16TSM | 2" | 780 | 78.5 | (101) | 50.5 | R 2 |
| | LB-20TSM | 2 1/2" | 980 | 84 | (113) | 66 | R 2 1/2 |
| | LB-24TSM | 3" | 1490 | 92 | (139) | 78.5 | R 3 |
| | LB-32TSM | 4" | 2080 | 92 | (167) | 103.5 | R 4 |

Plug L-PD type (Plug cap)

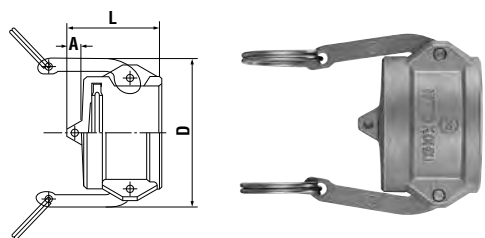

| Material | Model | Size | Mass (g) | Dimensions (mm) | | |
|-----------------|--------------|--------|----------|-----------------|------|-------|
| | | | | L | A | D |
| Aluminum alloy | L-6PD | 3/4" | 100 | 46 | 12 | (54) |
| | L-8PD | 1" | 145 | 54 | 11.5 | (62) |
| | L-10PD | 1 1/4" | 230 | 60 | 13 | (83) |
| | L-12PD | 1 1/2" | 295 | 68 | 17 | (91) |
| | L-16PD | 2" | 360 | 68 | 11 | (100) |
| | L-20PD | 2 1/2" | 435 | 72 | 15 | (113) |
| | L-24PD | 3" | 690 | 72 | 10 | (139) |
| | L-32PD | 4" | 870 | 76 | 15 | (167) |
| | Copper alloy | L-6PD | 3/4" | 220 | 45 | 11 |
| L-8PD | | 1" | 315 | 53 | 12 | (62) |
| L-10PD | | 1 1/4" | 610 | 61 | 13 | (84) |
| L-12PD | | 1 1/2" | 645 | 69 | 17.5 | (91) |
| L-16PD | | 2" | 830 | 68 | 11 | (100) |
| L-20PD | | 2 1/2" | 980 | 71 | 14 | (113) |
| L-24PD | | 3" | 1380 | 81 | 20 | (139) |
| L-32PD | | 4" | 2700 | 90 | 26 | (168) |
| Stainless steel | | L-6PD | 3/4" | 180 | 45 | 12 |
| | L-8PD | 1" | 265 | 52 | 11 | (63) |
| | L-10PD | 1 1/4" | 475 | 60 | 11 | (85) |
| | L-12PD | 1 1/2" | 545 | 63 | 15 | (87) |
| | L-16PD | 2" | 720 | 65 | 11 | (101) |
| | L-20PD | 2 1/2" | 945 | 71 | 15 | (113) |
| | L-24PD | 3" | 1420 | 72 | 12 | (139) |
| | L-32PD | 4" | 2055 | 77 | 14 | (167) |

Socket L-SD type (Socket cap)

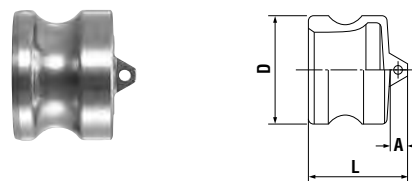

| Material | Model | Size | Mass (g) | Dimensions (mm) | | |
|-----------------|--------------|--------|----------|-----------------|------|-------|
| | | | | L | A | øD |
| Aluminum alloy | L-6SD | 3/4" | 35 | 32 | 8 | 32 |
| | L-8SD | 1" | 45 | 44 | 10 | 36.7 |
| | L-10SD | 1 1/4" | 70 | 57 | 14 | 45.5 |
| | L-12SD | 1 1/2" | 90 | 54 | 15 | 53.4 |
| | L-16SD | 2" | 140 | 62 | 13 | 63 |
| | L-20SD | 2 1/2" | 210 | 69 | 20 | 75.8 |
| | L-24SD | 3" | 290 | 71 | 15 | 91.5 |
| | L-32SD | 4" | 960 | 74 | 16 | 119.4 |
| | Copper alloy | L-6SD | 3/4" | 160 | 34 | 8 |
| L-8SD | | 1" | 150 | 44 | 10 | 36.7 |
| L-10SD | | 1 1/4" | 210 | 55 | 12 | 45.5 |
| L-12SD | | 1 1/2" | 290 | 54 | 15 | 53.4 |
| L-16SD | | 2" | 420 | 61 | 13 | 63 |
| L-20SD | | 2 1/2" | 630 | 69 | 19 | 75.7 |
| L-24SD | | 3" | 860 | 71 | 15 | 91.5 |
| L-32SD | | 4" | 1780 | 74.5 | 16 | 119.4 |
| Stainless steel | | L-6SD | 3/4" | 95 | 39 | 12 |
| | L-8SD | 1" | 145 | 45 | 12 | 37 |
| | L-10SD | 1 1/4" | 250 | 51 | 10 | 45 |
| | L-12SD | 1 1/2" | 300 | 54 | 14 | 53 |
| | L-16SD | 2" | 490 | 59.5 | 12.5 | 63 |
| | L-20SD | 2 1/2" | 710 | 64 | 14 | 76 |
| | L-24SD | 3" | 930 | 68 | 14 | 92 |
| | L-32SD | 4" | 1275 | 68 | 14 | 120 |

Models and Dimensions

Designs and specifications are subject to change for improvement without notice. / WAF : WAF stands for width across flats.

Plug LE type (Hose barb)

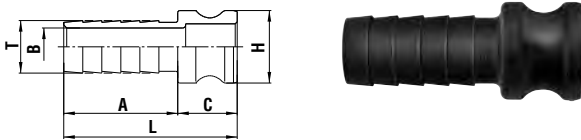

| Material | Model | Application (Hose) | Mass (g) | Dimensions (mm) | | | | | |
|----------|----------|--------------------|----------|-----------------|-------|--------|--------|------|------|
| | | | | L | A | C | ØH | ØT | ØB |
| Plastic | LE-6TPH | 3/4" | 16 | 74.5 | 51.5 | (23) | (32) | 20.7 | 14.2 |
| | LE-8TPH | 1" | 29 | 87.5 | 57.5 | (30) | (36.5) | 26.3 | 19 |
| | LE-12TPH | 1 1/2" | 73 | 103 | 61.5 | (41.5) | (53.5) | 40 | 30 |
| | LE-16TPH | 2" | 122 | 119 | 71 | (48) | (63) | 52.5 | 41 |
| | LE-24TPH | 3" | 221 | 151.5 | 106.5 | (45) | (91.5) | 77 | 64.5 |

Socket LC type (Hose barb)

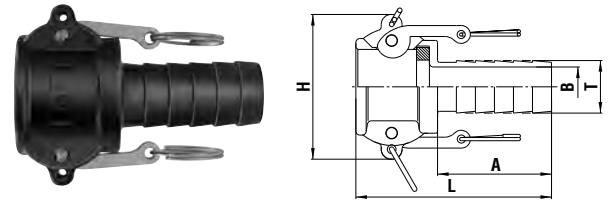

| Material | Model | Application (Hose) | Mass (g) | Dimensions (mm) | | | | |
|----------|----------|--------------------|----------|-----------------|------|---------|------|------|
| | | | | L | A | H | ØT | ØB |
| Plastic | LC-6TSH | 3/4" | 64 | 83 | 52 | (63.5) | 20.2 | 14 |
| | LC-8TSH | 1" | 104 | 97.5 | 56.5 | (73) | 26.2 | 20 |
| | LC-12TSH | 1 1/2" | 242 | 109.5 | 60.5 | (95) | 39 | 29.5 |
| | LC-16TSH | 2" | 269 | 125 | 70.5 | (105.5) | 52.5 | 41 |
| | LC-24TSH | 3" | 527 | 161 | 102 | (136.5) | 77 | 64.5 |

Plug LA type (Female thread)



| Material | Model | Application (Thread) | Mass (g) | Dimensions (mm) | | | | |
|----------|----------|----------------------|----------|-----------------|--------|------------|------|----------|
| | | | | L | C | H(WAF) | ØB | T |
| Plastic | LA-6TPF | 3/4" | 19 | 42 | (26) | Hex.34 | 21.3 | Rc 3/4 |
| | LA-8TPF | 1" | 27 | 59 | (34) | Hex.43 | 22 | Rc 1 |
| | LA-12TPF | 1 1/2" | 65 | 67 | (42) | Ribbed 65 | 36.6 | Rc 1 1/2 |
| | LA-16TPF | 2" | 102 | 73 | (47.5) | Ribbed 78 | 42 | Rc 2 |
| | LA-24TPF | 3" | 211 | 90 | (52.5) | Ribbed 108 | 71 | Rc 3 |

Socket LD type (Female thread)

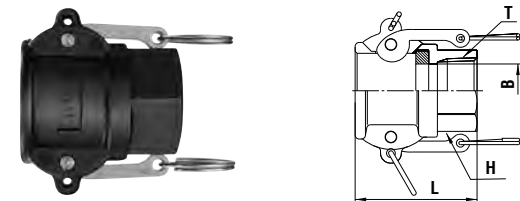

| Material | Model | Application (Thread) | Mass (g) | Dimensions (mm) | | | |
|----------|----------|----------------------|----------|-----------------|------------|------|----------|
| | | | | L | H(WAF) | ØB | T |
| Plastic | LD-6TSF | 3/4" | 65 | 49 | Hex.32 | 21.5 | Rc 3/4 |
| | LD-8TSF | 1" | 98 | 61 | Hex.41 | 27 | Rc 1 |
| | LD-12TSF | 1 1/2" | 260 | 77.5 | Ribbed 68 | 39 | Rc 1 1/2 |
| | LD-16TSF | 2" | 285 | 83 | Ribbed 80 | 51 | Rc 2 |
| | LD-24TSF | 3" | 444 | 90.5 | Ribbed 109 | 77.5 | Rc 3 |

Plug LF type (Male thread)

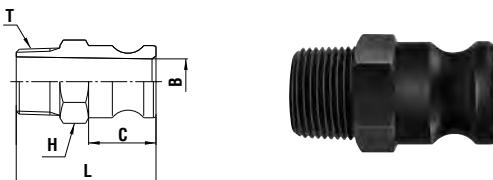

| Material | Model | Application (Thread) | Mass (g) | Dimensions (mm) | | | | |
|----------|----------|----------------------|----------|-----------------|--------|------------|------|---------|
| | | | | L | C | H(WAF) | ØB | T |
| Plastic | LF-6TPM | 3/4" | 23 | 60 | (26) | Hex.32 | 19 | R 3/4 |
| | LF-8TPM | 1" | 19 | 71 | (34) | Hex.37 | 23 | R 1 |
| | LF-12TPM | 1 1/2" | 72 | 77 | (42) | Ribbed 63 | 32 | R 1 1/2 |
| | LF-16TPM | 2" | 105 | 84.5 | (48) | Ribbed 74 | 44.5 | R 2 |
| | LF-24TPM | 3" | 210 | 102.5 | (51.5) | Ribbed 100 | 72 | R 3 |

Socket LB type (Male thread)

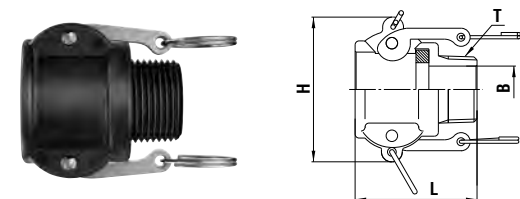

| Material | Model | Application (Thread) | Mass (g) | Dimensions (mm) | | | |
|----------|----------|----------------------|----------|-----------------|---------|------|---------|
| | | | | L | H | ØB | T |
| Plastic | LB-6TSM | 3/4" | 58 | 49.5 | (63.5) | 19 | R 3/4 |
| | LB-8TSM | 1" | 88 | 61 | (73) | 23.5 | R 1 |
| | LB-12TSM | 1 1/2" | 227 | 77.5 | (95) | 37 | R 1 1/2 |
| | LB-16TSM | 2" | 251 | 82.5 | (105.5) | 48 | R 2 |
| | LB-24TSM | 3" | 397 | 88 | (136.5) | 75 | R 3 |

Plug L-PD type (Plug cap)

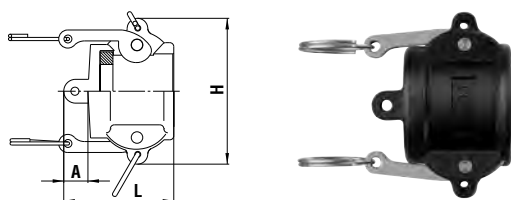

| Material | Model | Size | Mass (g) | Dimensions (mm) | | |
|----------|--------|--------|----------|-----------------|------|--------|
| | | | | L | A | H |
| Plastic | L-6PD | 3/4" | 60 | 45 | 12 | (63.5) |
| | L-8PD | 1" | 94 | 55.5 | 12 | (73) |
| | L-12PD | 1 1/2" | 214 | 65 | 15 | (95) |
| | L-16PD | 2" | 219 | 70.5 | 16 | (106) |
| | L-24PD | 3" | 408 | 77 | 17.5 | (136) |

Socket L-SD type (Socket cap)



| Material | Model | Size | Mass (g) | Dimensions (mm) | | |
|----------|--------|--------|----------|-----------------|----|--------|
| | | | | L | A | ØD |
| Plastic | L-6SD | 3/4" | 10 | 35.5 | 12 | (32.1) |
| | L-8SD | 1" | 18 | 42.5 | 11 | (36.5) |
| | L-12SD | 1 1/2" | 46 | 53.5 | 14 | (53.2) |
| | L-16SD | 2" | 68 | 63 | 16 | (63) |
| | L-24SD | 3" | 102 | 71 | 18 | (91) |