

For Multi-Port Connection (Manual)

Multi Cupla MAM Type

Multiple air port system

Working pressure



0.7 MPa
(7 kgf/cm²)

Valve structure



One-way shut-off

Applicable fluid



Air

**Simultaneously connects several ports securely in one operation!
Greatly cuts cycle time in multiple ports replacement.**

- Handles several ports at once.
- Simple action with lever enables easy connection / disconnection manually.
- Comes with lock mechanism to prevent accidental disconnection.
- Valve on socket side only.

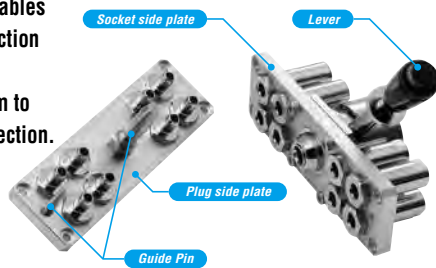

Specifications

Body material	Cupla : Brass (Chrome plated)			
	Plate : Aluminum alloy (4, 8, 12 ports) / Plate : Steel (16 ports) Locking unit : Steel and others			
Size (Thread)	Rc 1/8			
Pressure unit	MPa	kgf/cm ²	bar	PSI
Working pressure	0.7	7	7	102
Seal material	Seal material	Mark		Working temperature range
Working temperature range	Nitrile rubber	NBR (SG)		-20°C to +60°C

Max. Tightening Torque

Nm (kgf·cm)

Torque	5 {51}
--------	--------

Interchangeability

No connection is possible between plates with different number of ports.

Min. Cross-Sectional Area

(mm²)

Per port	15.9
----------	------

Suitability for Vacuum

Not suitable for vacuum application in either connected or disconnected condition.

Pressure - Flow Characteristics

Per port with Cupla

[Test conditions] • Fluid : Air • Temperature : Room temperature

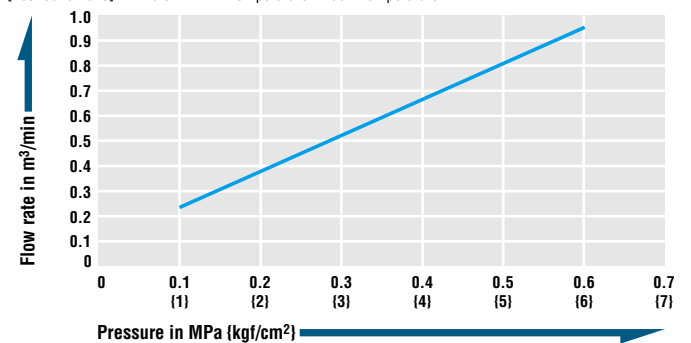

Models and Dimensions

WAF : WAF stands for width across flats.

Model MAM-1TP-4 × MAM-1S-4 (4 ports type)

Application: R 1/8 Mass: 150 g (Plug), 500 g (Socket)

Plug: Model **MAM-1TP-4**

Socket: Model **MAM-1S-4**

Dimensions (mm)

MAM-1TP-4 × MAM-1S-4
(4 ports type)

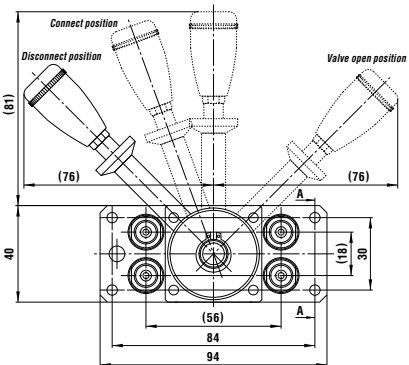
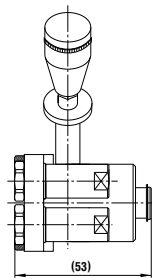
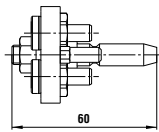
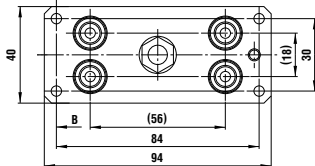
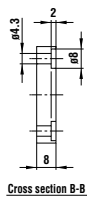
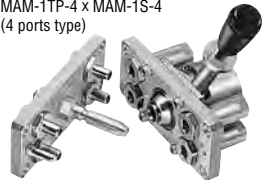

Cross section A-A

Model MAM-1TP-8 × MAM-1S-8 (8 ports type)

Application: R 1/8 Mass: 250 g (Plug), 650 g (Socket)

Plug: Model **MAM-1TP-8**

Socket: Model **MAM-1S-8**

Dimensions (mm)

MAM-1TP-8 × MAM-1S-8
(8 ports type)

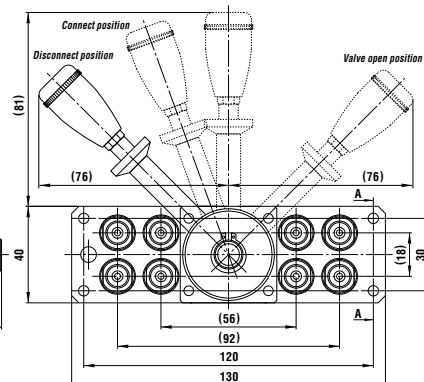
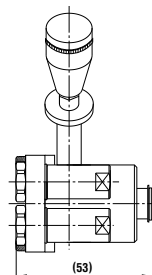
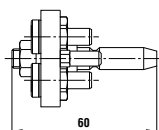
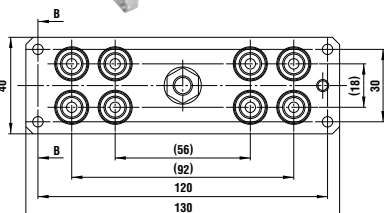
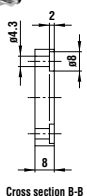
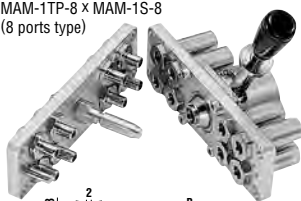

Cross section A-A

