

For High Purity Chemicals

Semicon Cupla

SCS Type

For semiconductor manufacturing equipment

Working pressure



Valve structure



Applicable fluids

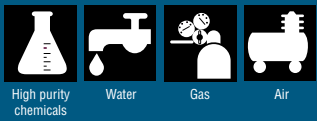

Adopted stainless steel body and fluorine contained resin valves.

- The body and spring material of stainless steel (SUS304), and valve of fluorine contained resin ensure excellent performance with various chemicals.
- Body (SUS304) is electropolished for enhanced corrosion resistance.
- All components are cleaned, assembled, inspected, and then packed in a clean room.
- Grease free. Grease is not applied to the seal material.
- Plug comes with a dust cap.

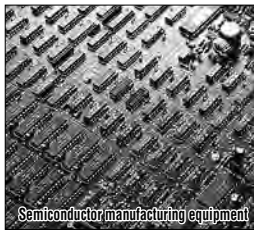

Specifications

Body material	Electropolished stainless steel (SUS304)				
Size (Thread)	1/8", 1/4", 3/8", 1/2", 3/4", 1" 1/8-27NPT, 1/4-18NPT, 19/32-18UNS				
Pressure unit	MPa	kgf/cm ²	bar	PSI	
Working pressure	0.2	2	2	29	
Seal material	Socket	Seal material	Mark	Working temperature range	Remarks
	O-ring	Perfluoroelastomer	P	0°C to +50°C	
Working temperature range	Valve	Fluoropolymer resin (Socket: PFA, Plug: PTFE except 1P and 2P of PFA)			

*If you need a seal material other than perfluoroelastomer, please consult with us.

Max. Tightening Torque

Nm (kgf·cm)

Size	1/8-27NPT Rc 1/8	1/4-18NPT Rc 1/4	19/32-18UNS	Rc 3/8	Rc 1/2	Rc 3/4	Rc 1
Torque	9 (92)	14 (143)	20 (204)	22 (224)	60 (612)	90 (918)	120 (1224)

Interchangeability

The model name [SCS-□S (P)] with the same digit in □ are interchangeable regardless of end configurations.

Interchangeability Check List (SCS Type, SCY Type)

● indicates connection capability except for made-to-order products.

Plug	Model	Socket							
		SCS Type				SCY Type			
		-1S	-2S	-1S	-2S	-3S	-4S	-6S	-8S
SCS Type	-1P	●		●					
	-2P		●		●				
	-3P					●			
	-4P						●		
	-6P							●	
	-8P								●

Min. Cross-Sectional Area

(mm²)

Model	SCS-1SP	SCS-2SP	SCS-3P	SCS-4P	SCS-6P	SCS-8P
Min. cross-sectional area	15	23	28	71	110	162

Flow Rate – Pressure Loss Characteristics

[Test conditions] • Fluid : Water • Temperature : 21°C to 32°C

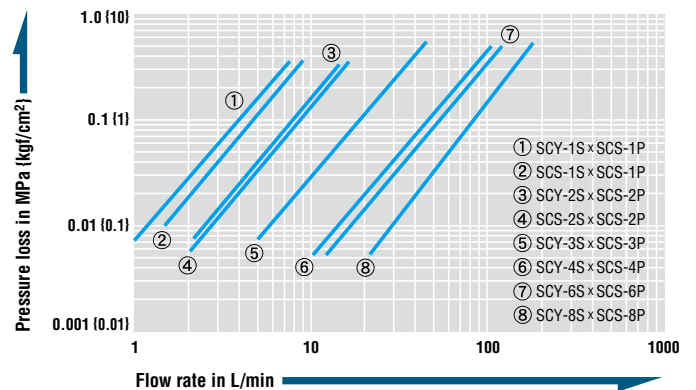

Models and Dimensions

WAF : WAF stands for width across flats.

Plug Female thread

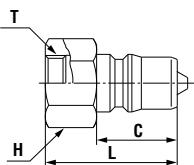

Model	Container capacity	Mass (g)	Dimensions (mm)			
			L	C	H(WAF)	T
SCS-1P	For 10L to 20L	17	29	19	Hex.14	Rc 1/8
SCS-1P-NPT	For 10L to 20L					1/8-27NPT
SCS-1P-UNS	For 10L to 20L	34	33	19	Hex.21	19/32-18UNS
SCS-2P	For 10L to 20L	32	34	22	Hex.17	Rc 1/4
SCS-2P-NPT	For 10L to 20L	29				1/4-18NPT
SCS-2P-UNS	For 10L to 20L	41	36	22	Hex.21	19/32-18UNS
SCS-3P	For 100L to 200L	61	40	25	Hex.21	Rc 3/8
SCS-4P	For 100L to 200L	114	44	28	Hex.29	Rc 1/2
SCS-6P	For 100L to 200L	198	52	36	Hex.35	Rc 3/4
SCS-8P	For 100L to 200L	338	62	40	Hex.41	Rc 1

Socket Female thread

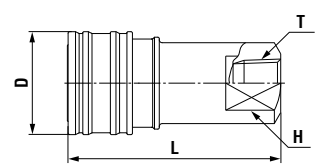

Model	Container capacity	Mass (g)	Dimensions (mm)			
			L	øD	H(WAF)	T
SCS-1S-NPT	For 10L to 20L	84	48	24	14	1/8-27NPT
SCS-2S-NPT	For 10L to 20L	138	58	28	19	1/4-18NPT

Before use, please be sure to read "Safety Guide" described at the end of this book and "Instruction Sheet" that comes with the products.