

HS07-1624

Allowable Max. Pressure

104,380 lbs (52ton)

Max. Punching Thickness: 5/8" (A36)

Max. Punching Diameter: 15/16"

MODEL

HS07-1624

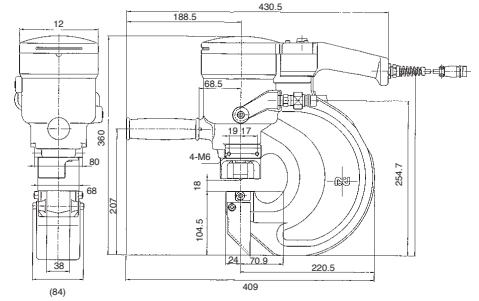

Specifications

Model	HS07-1624	
Max. Throat Depth	inch (mm)	2-3/4" (70)
Punching capacity	inch (mm)	Max. Punching Diameter Max. Punching Thickness
Mild Steel A36		15/16" (24) 5/8" (16)
Stainless Steel 304		15/16" (24) 1/4" (6)
Hole Making Time	Punching Time 11.8 sec. Returning Time 5.7 sec.	
Allowable Max. Pressure	10,000 psi (700 kgf/cm ²)	
Max. Output	lbs (ton)	104,380 (52)
Ram Stroke	inch (mm)	1" (25)
Mass (Weight)	lbs (kg)	56 (25.5)

*Can be modified to accept 1-1/16" punch & die. Consult factory.

Standard Accessories for HS07-1624

- Hose kit assembly
- Hose cord assembly
- Sub handle assembly
- Tool box
- 4 mm Allen wrench
- #12 Spanner wrench
- 22 mm "D" series punch & die
- Chip guard assembly
- Spanner